

Rubber Mounts Type NR / NRD

Single and Double Deflection Rubber

APPLICATION

Used where a low cost mounting is required for effective isolation of noise and vibration from equipment with speeds of 1,000 RPM upwards.

- Pumps and fans
- Generator sets
- General industrial equipment
- Mobile equipment
- Electrical transformers
- Packaged air conditioning equipment

FEATURES

- 5 to 12mm static deflection
- Threaded top insert
- Non-skid ribbed base
- Colour coded load range
- Corrosion resistant

OPTIONS

- Moulded in alternative elastomers (special order)
- Internal plates can be supplied in stainless steel
- Can be supplied with levelling bolt for the NR2, NR3, NRD2, NRD3 (see NRL picture)
- Can be supplied with oil caps
- NL Mount option (through hole in top plate)

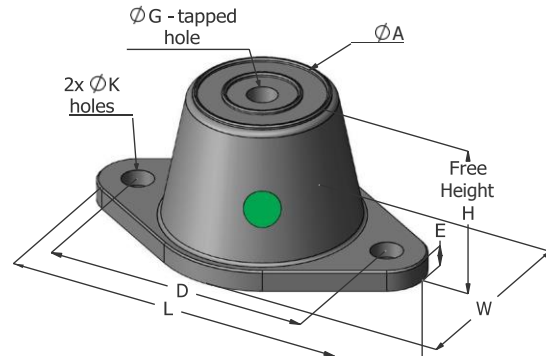

NR / NRD

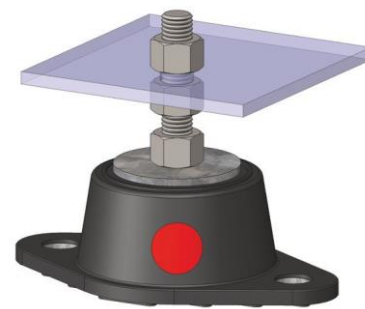

NRL MOUNT

NR / NRD PRODUCT GUIDE

| Type | Colour | Max Load kg | Dynamic Factor | Stat. Defl. | | Height (H) | | L mm | W mm | D mm | A mm | G Dia | K mm | E mm |
|-------------------|--------|-------------|----------------|-------------|--------|------------|--------|------|------|------|------|-----------------|------|------|
| | | | | NR mm | NRD mm | NR mm | NRD mm | | | | | | | |
| NR1 or NRD1 | Blue | 17 | 1.0 | 5 | 8 | 28 | 35 | 80 | 45 | 60 | 36 | M10 (NL Ø12) | 8.5 | 5 |
| | White | 25 | 1.0 | | | | | | | | | | | |
| | Red | 40 | 1.2 | | | | | | | | | | | |
| | Green | 55 | 1.3 | | | | | | | | | | | |
| | Yellow | 80 | 1.4 | | | | | | | | | | | |
| NR2 or NRD2 | White | 70 | 1.1 | 6 | 10 | 32 | 44 | 98 | 60 | 76 | 45 | M10 (NL Ø12) | 8.5 | 6 |
| | Red | 100 | 1.2 | | | | | | | | | | | |
| | Green | 160 | 1.4 | | | | | | | | | | | |
| | Yellow | 250 | 1.5 | | | | | | | | | | | |
| | | | | | | | | | | | | | | |
| NR3 or NRD3 | White | 145 | 1.2 | 6 | 12 | 44 | 72 | 140 | 85 | 104 | 68 | M12 (NL Ø14) | 14 | 7 |
| | Red | 200 | 1.3 | | | | | | | | | | | |
| | Green | 300 | 1.4 | | | | | | | | | | | |
| | Yellow | 500 | 1.6 | | | | | | | | | | | |
| | | | | | | | | | | | | | | |
| NR4 or NRD4 | Blue | 380 | 1.2 | 6 | 12 | 46 | 76 | 166 | 110 | 128 | 100 | M16 (NL Ø18) | 14 | 9 |
| | White | 580 | 1.4 | | | | | | | | | | | |
| | Red | 850 | 1.5 | | | | | | | | | | | |
| | Green | 1,300 | 1.6 | | | | | | | | | | | |
| | | | | | | | | | | | | | | |

CONSTRUCTION

Material: Black filled natural rubber; UV and ozone inhibited. Metal components are corrosion protected and embedded in the elastomer.

PERFORMANCE CHARACTERISTICS

Axial Loads: See Table – Load/deflection is close to linear from 10% to 100% loads.

Shear Loads: Shear/axial stiffness; NR series = 0.3; NRD series = 0.2.

Creep: Maximum 4% deflection per decade of time (ref 1 minute).

DYNAMIC CHARACTERISTICS

Rubber mountings differ from spring mountings in that the natural frequency is a function not only of deflection, but also of the rubber hardness (durometer).

The natural frequency is usually greater than indicated by static deflection alone. For effective assessment of natural frequency, multiply natural frequency obtained from static deflection by the dynamic factor given in the table.

INSTALLATION

Type NR mountings are designed to carry the load on the full surface of the top face. The tapped centre hole must only be used for bolting down equipment to the mounting, and not as a jacking point for levelling. If levelling is necessary this can be done with the NRL option (see NRL picture).

BOLTING DOWN

Where bolting is required, washers should be used and the manufacturers recommended bolt torque not exceeded.

For installations with limited access to the top hole, a metal thread screw can be threaded up through the bottom of the mounting (see table for thread size). Care must be taken to ensure that clearance under the screw head (h) exceeds the design deflection of the mounting.

MOBILE MOUNTING

A restraining bolt is recommended for mobile and marine applications to control inertia forces.

Mobile Mountings are coded NRB1 to NRB4 and have the same load deflection characteristics as the stationary mountings (NR1 to NR4).

It is recommended that for mobile use, mountings be loaded under static conditions to only 60% of maximum rated capacity.

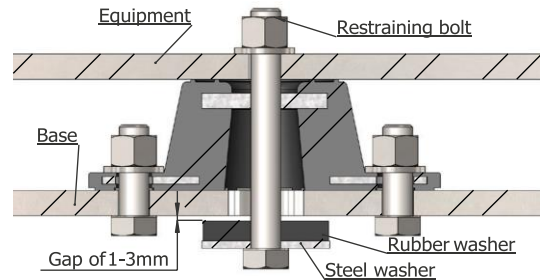

NRB MOBILE MOUNTING ASSEMBLY

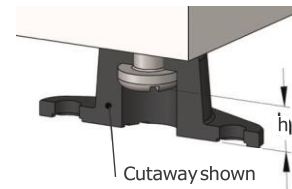

BRACKET MOUNTING ASSEMBLY INACCESSIBLE

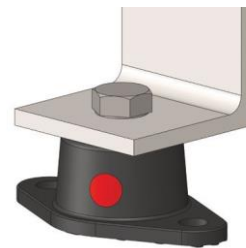

BRACKET MOUNTING ASSEMBLY

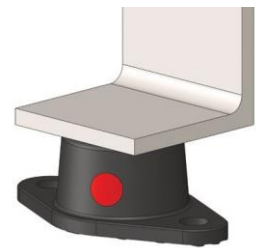

BRACKET MOUNTING ASSEMBLY NO BOLT

TECHNICAL ASSISTANCE

All Embelton offices can provide detailed technical assistance on the use of this equipment in specific applications.

CONDITIONS OF SALE

These products are sold subject to the published Embelton General Conditions of Sale, copies of which may be inspected on request.

SPECIFICATION

Rubber mountings, colour coded for identification of load capacity, shall have a minimum deflection under rated load of 5mm, incorporating separate steel top and base plates completely embedded in the elastomer. They shall have non-skid mounting surfaces to make bolting down generally unnecessary although bolt holes are to be incorporated. They will be type NR (NRD) as supplied by Embelton.